

FRONT ELEVATION

SCHEDULE OF DOORS & WINDOWS

NO.	SILL	LINTEL	SIZE
D	2150	2150	1200 X 2150
D1	2150	2150	900 X 2150
D1a	250	2500	900 X 2050
D2	2150	2150	700 X 2150
D2a	2150	2150	1000 X 2150
D3	2150	2150	1000 X 2150
D4	2150	2150	2885 X 2400
DW1	2400	2400	2845 X 2400
SD	2150	2150	2100 X 2150
SD1	2150	2150	1500 X 2150
F.C.D	2150	2150	1125 X 2150
F.C.D1	2150	2150	1188 X 2150
W	350	2150	2400 X 1800
W1	350	2150	2100 X 1800
W2	350	2150	1200 X 1800
W3	350	2150	850 X 1800
W4	1100	2150	1200 X 1050
W5	1250	2150	600 X 900
W6	350	2150	1200 X 1800
W7	750	2150	700 X 1400
SW	750	2450	1188 X 1700

**CERTIFICATE OF STRUCTURAL ENGINEER**

CERTIFY THAT THE STRUCTURAL DRAWING AND DESIGN OF BOTH THE FOUNDATION AND SUPERSTRUCTURE OF THE PROJECT HAS BEEN CHECKED AND FOUND TO BE IN ACCORDANCE WITH THE RULES AND REGULATIONS MADE UNDER THE ACT AND ALSO CONSIDERING ALL POSSIBLE LOADS, SEISMIC LOAD AND THE MOMENTS GENERATED BY THE PROPOSED STRUCTURE AS PER THE BUREAU OF INDIAN STANDARD AND NATIONAL BUILDING CODE OF INDIA AND CERTIFIED THAT IT IS SAFE AND STABLE IN ALL RESPECT AND THESE PROVISIONS SHALL BE ADHERED TO DURING THE CONSTRUCTION.

**SANJIV J. PAREKH**  
 V.L. STRUCTURE, CONST. ENG., A.  
 R.C.E., FIE(F-115654-5)  
 SPEK/ANDRA/10/00030

**CERTIFICATE OF ARCHITECT**

I CERTIFY THAT ALL THE ARCHITECTURAL DRAWINGS OF THE PROJECT AT R.S.DAG NOS.473,474,475,476,477,478,479,480/10/00030, 500, 501(P), 502(P), 503(P), 504(P), 506(P), 507(P), 509(P), 520(P), 521, 525, 526, 529, 530, 532, 533, 534, 535, 536, 537, 538, 539, 540, 541, 542, 543, 544, 545, 546, 547, 548, 549, 550, 551, 552, 553, 554, 555, 556, 557, 558, 559, 560, 561, 562, 563, 564, 565, 566, 567, 568, 569, 570, 571, 572, 573, 574, 575, 576, 577, 578, 579, 580, 581, 582, 583, 584, 585, 586, 587, 588, 589, 590, 591, 592, 593, 594, 595, 596, 597, 598, 599, 600, 601, 602, 603, 604, 605, 606, 607, 608, 609, 610, 611, 612, 613, 614, 615, 616, 617, 618, 619, 620, 621, 622, 623, 624, 625, 626, 627, 628, 629, 630, 631, 632, 633, 634, 635, 636, 637, 638, 639, 640, 641, 642, 643, 644, 645, 646, 647, 648, 649, 650, 651, 652, 653, 654, 655, 656, 657, 658, 659, 660, 661, 662, 663, 664, 665, 666, 667, 668, 669, 670, 671, 672, 673, 674, 675, 676, 677, 678, 679, 680, 681, 682, 683, 684, 685, 686, 687, 688, 689, 690, 691, 692, 693, 694, 695, 696, 697, 698, 699, 700, 701, 702, 703, 704, 705, 706, 707, 708, 709, 710, 711, 712, 713, 714, 715, 716, 717, 718, 719, 720, 721, 722, 723, 724, 725, 726, 727, 728, 729, 730, 731, 732, 733, 734, 735, 736, 737, 738, 739, 740, 741, 742, 743, 744, 745, 746, 747, 748, 749, 750, 751, 752, 753, 754, 755, 756, 757, 758, 759, 760, 761, 762, 763, 764, 765, 766, 767, 768, 769, 770, 771, 772, 773, 774, 775, 776, 777, 778, 779, 780, 781, 782, 783, 784, 785, 786, 787, 788, 789, 790, 791, 792, 793, 794, 795, 796, 797, 798, 799, 800, 801, 802, 803, 804, 805, 806, 807, 808, 809, 810, 811, 812, 813, 814, 815, 816, 817, 818, 819, 820, 821, 822, 823, 824, 825, 826, 827, 828, 829, 830, 831, 832, 833, 834, 835, 836, 837, 838, 839, 840, 841, 842, 843, 844, 845, 846, 847, 848, 849, 850, 851, 852, 853, 854, 855, 856, 857, 858, 859, 860, 861, 862, 863, 864, 865, 866, 867, 868, 869, 870, 871, 872, 873, 874, 875, 876, 877, 878, 879, 880, 881, 882, 883, 884, 885, 886, 887, 888, 889, 890, 891, 892, 893, 894, 895, 896, 897, 898, 899, 900, 901, 902, 903, 904, 905, 906, 907, 908, 909, 910, 911, 912, 913, 914, 915, 916, 917, 918, 919, 920, 921, 922, 923, 924, 925, 926, 927, 928, 929, 930, 931, 932, 933, 934, 935, 936, 937, 938, 939, 940, 941, 942, 943, 944, 945, 946, 947, 948, 949, 950, 951, 952, 953, 954, 955, 956, 957, 958, 959, 960, 961, 962, 963, 964, 965, 966, 967, 968, 969, 970, 971, 972, 973, 974, 975, 976, 977, 978, 979, 980, 981, 982, 983, 984, 985, 986, 987, 988, 989, 990, 991, 992, 993, 994, 995, 996, 997, 998, 999, 1000.

**RONAL AGRawal**  
 Reg. Architect  
 New Town Kolkata Development Authority  
 Enrolment No. ACH/KOL/0190023

**SIGNATURE OF GEO - TECHNICAL ENGINEER**

IT IS CERTIFIED THAT THE COMPREHENSIVE GEO-TECHNICAL REPORT ON SOIL INVESTIGATION HAS BEEN PREPARED BY ME FOR DESIGN AND CALCULATION OF THE FOUNDATION BY ANALYZING THE SOIL SAMPLES FOR ESTIMATING THE BEARING CAPACITY OF THE SOIL ON WHICH FOUNDATION OF THE STRUCTURE WILL BE CONSTRUCTED. I SHALL ALSO CONDUCT THIS INVESTIGATION AFTER EXCAVATION AT THE APPROPRIATE DEPTH THAT HAS BEEN PROPOSED IN THE GEO-TECHNICAL REPORT.

**SIGNATURE OF GEO - TECHNICAL ENGINEER**

*Subir Ranjan Sarker*  
 Regd. Town Planner  
 New Town Kolkata Development Authority  
 Enrolment No.: TPER/INDIA/10/00035

**SIGNATURE OF TOWN PLANNER OR URBAN DESIGNER**

*Sanjib Guha*  
 BSC, BCE, FIE-(F-115654-5)  
 CHARTERED ENGINEER  
 STRV/INDIA/F-10/00033

**SIGNATURE OF STRUCTURAL REVIEWER**

TITLE FRONT ELEVATION (TOWER 2F)

**PROJECT:**  
 REVISED (G-11), (B-G-VII) AND (G-VI) STORED RESIDENTIAL BUILDINGS AT MOUZA - BHATENDRA, R.S.DAG NOS.473, 474, 475, 476, 477, 478, 479, 480, 481, 482, 483, 484, 485, 486, 487, 488, 489, 490, 491, 492, 493, 494, 495, 496, 497, 498, 499, 500, 501(P), 502(P), 503(P), 504(P), 506(P), 507(P), 509(P), 520(P), 521, 525, 526, 529, 530, 532, 533, 534, 535, 536, 537, 538, 539, 540, 541, 542, 543, 544, 545, 546, 547, 548, 549, 550, 551, 552, 553, 554, 555, 556, 557, 558, 559, 560, 561, 562, 563, 564, 565, 566, 567, 568, 569, 570, 571, 572, 573, 574, 575, 576, 577, 578, 579, 580, 581, 582, 583, 584, 585, 586, 587, 588, 589, 590, 591, 592, 593, 594, 595, 596, 597, 598, 599, 600, 601, 602, 603, 604, 605, 606, 607, 608, 609, 610, 611, 612, 613, 614, 615, 616, 617, 618, 619, 620, 621, 622, 623, 624, 625, 626, 627, 628, 629, 630, 631, 632, 633, 634, 635, 636, 637, 638, 639, 640, 641, 642, 643, 644, 645, 646, 647, 648, 649, 650, 651, 652, 653, 654, 655, 656, 657, 658, 659, 660, 661, 662, 663, 664, 665, 666, 667, 668, 669, 670, 671, 672, 673, 674, 675, 676, 677, 678, 679, 680, 681, 682, 683, 684, 685, 686, 687, 688, 689, 690, 691, 692, 693, 694, 695, 696, 697, 698, 699, 700, 701, 702, 703, 704, 705, 706, 707, 708, 709, 710, 711, 712, 713, 714, 715, 716, 717, 718, 719, 720, 721, 722, 723, 724, 725, 726, 727, 728, 729, 730, 731, 732, 733, 734, 735, 736, 737, 738, 739, 740, 741, 742, 743, 744, 745, 746, 747, 748, 749, 750, 751, 752, 753, 754, 755, 756, 757, 758, 759, 760, 761, 762, 763, 764, 765, 766, 767, 768, 769, 770, 771, 772, 773, 774, 775, 776, 777, 778, 779, 780, 781, 782, 783, 784, 785, 786, 787, 788, 789, 790, 791, 792, 793, 794, 795, 796, 797, 798, 799, 800, 801, 802, 803, 804, 805, 806, 807, 808, 809, 810, 811, 812, 813, 814, 815, 816, 817, 818, 819, 820, 821, 822, 823, 824, 825, 826, 827, 828, 829, 830, 831, 832, 833, 834, 835, 836, 837, 838, 839, 840, 841, 842, 843, 844, 845, 846, 847, 848, 849, 850, 851, 852, 853, 854, 855, 856, 857, 858, 859, 860, 861, 862, 863, 864, 865, 866, 867, 868, 869, 870, 871, 872, 873, 874, 875, 876, 877, 878, 879, 880, 881, 882, 883, 884, 885, 886, 887, 888, 889, 890, 891, 892, 893, 894, 895, 896, 897, 898, 899, 900, 901, 902, 903, 904, 905, 906, 907, 908, 909, 910, 911, 912, 913, 914, 915, 916, 917, 918, 919, 920, 921, 922, 923, 924, 925, 926, 927, 928, 929, 930, 931, 932, 933, 934, 935, 936, 937, 938, 939, 940, 941, 942, 943, 944, 945, 946, 947, 948, 949, 950, 951, 952, 953, 954, 955, 956, 957, 958, 959, 960, 961, 962, 963, 964, 965, 966, 967, 968, 969, 970, 971, 972, 973, 974, 975, 976, 977, 978, 979, 980, 981, 982, 983, 984, 985, 986, 987, 988, 989, 990, 991, 992, 993, 994, 995, 996, 997, 998, 999, 1000.

JURISDICTION OF RAJARHAT BISHNUPUR NO. 1 GRAM PANCHAYAT, DIST - NORTCH 24 PARGANAS, PREVIOUSLY SANCTIONED AND APPROVED BY EXECUTIVE OFFICER OF RAJARHAT PANCHAYAT SAMITY, DATED 15/12/15

Authorized Signatory

SIGNATURE OF OWNER

**NAME OF THE COMPANY**

- 1. M/s. Adya Real Estates Private Limited
- 2. M/s. Aliah Supply Private Limited
- 3. M/s. Anchor Vanija Private Limited
- 4. M/s. Anirama Advisory Private Limited
- 5. M/s. Anirama Dealers Private Limited
- 6. M/s. Anirama Supply Private Limited
- 7. M/s. Anirama Hirse Private Limited
- 8. M/s. Arch Vanija Private Limited
- 9. M/s. Arpana Consultancy Private Limited
- 10. M/s. Arpana Tie Up Private Limited
- 11. M/s. Ardhra Homes Private Limited
- 12. M/s. Ardhra Projects Private Limited
- 13. M/s. Ardhra Real Estate Private Limited
- 14. M/s. Average Complex Private Limited
- 15. M/s. Average Housing Private Limited
- 16. M/s. Average Infracon Private Limited
- 17. M/s. Average Nirman Private Limited
- 18. M/s. Average Projects Private Limited
- 19. M/s. Basudev Enclave Private Limited
- 20. M/s. Basudev Housing Private Limited
- 21. M/s. Bluebird Tie Up Private Limited
- 22. M/s. Boomer Heights Private Limited
- 23. M/s. Boomer Hirse Private Limited
- 24. M/s. Brighnum Agents Private Limited
- 25. M/s. Brighnum Tie Up Private Limited
- 26. M/s. Crossway Vspaar Private Limited
- 27. M/s. Crossway Heights Private Limited
- 28. M/s. Crossway Reman Private Limited
- 29. M/s. Crossway Tie Up Private Limited
- 30. M/s. Deyanath Suppliers Private Limited
- 31. M/s. Deita Vspaar Private Limited
- 32. M/s. Dhanga Hirse Private Limited
- 33. M/s. Dhanga Real Estate Private Limited
- 34. M/s. Dhanga Residency Private Limited
- 35. M/s. Dressed Hirse Private Limited
- 36. M/s. Elegant Nirman Private Limited
- 37. M/s. Galadani Nirman Private Limited
- 38. M/s. Galadani Buldcon Private Limited
- 39. M/s. Galadani Constructions Private Limited
- 40. M/s. Galadani Hirse Private Limited
- 41. M/s. Galadani Realty Private Limited
- 42. M/s. Galadani Enclave Private Limited
- 43. M/s. Galadani Homes Private Limited
- 44. M/s. Galadani Nirman Private Limited
- 45. M/s. Galadani Projects Private Limited
- 46. M/s. Galadani Resale Private Limited
- 47. M/s. Galadani Real Estate Private Limited
- 48. M/s. Ganesh Tracem Private Limited
- 49. M/s. Ganesh Promoters Private Limited
- 50. M/s. Green Top Nirman Private Limited
- 51. M/s. Guidance Vspaar Private Limited
- 52. M/s. Gullmar Vspaar Private Limited
- 53. M/s. Hanurang Tie Up Private Limited
- 54. M/s. Indlar Tracem Private Limited
- 55. M/s. Jainendra Distributors Private Limited
- 56. M/s. Jainendra Marketing Private Limited
- 57. M/s. Jainendra Merchants Private Limited
- 58. M/s. Jainendra Advisory Private Limited
- 59. M/s. Jainendra Tie Up Private Limited
- 60. M/s. Jilmiti Sales Private Limited
- 61. M/s. Jilmiti Vspaar Private Limited
- 62. M/s. Jiny Merchants Private Limited
- 63. M/s. Juh Marketing Private Limited

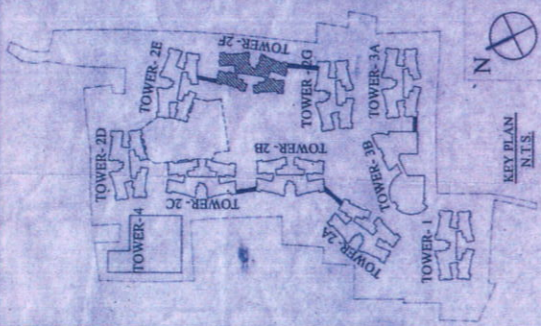

KEY PLAN  
 N.T.S.

